

# High-Pressure Pressure Transmitter

## Model: ZJX-PA-S1



### PRODUCT FEATURES AND APPLICATION FIELDS

**Description:**

The ZJX-PA-S1 high-pressure pressure transmitter adopts micro solution technology, using high-temperature glass to melt the components onto the isolation membrane, while also avoiding P-N junction phenomenon. This product also has characteristics such as high pressure resistance (600MPa) and high stability.

**Advantages:**

High pressure resistance 600MPa

Special structural design ensures pressure resistance and bearing capacity

Different sealing structures ensure stable performance

Multiple batches of fatigue compression and aging ensure product reliability

Support OEM/ODM customization

**Application:**

Water jet equipment

Isostatic pressure equipment

Fluid equipment

Food Pharmaceuticals

New energy vehicles

Hydromechanical

Water treatment

**Features:**

## PRODUCT PARAMETERS

Measuring Range	0~6000bar
Output/Communication	4-20mA,0-5V,0.5-4.5V,0-10V,RS485
Accuracy	0.25%F.S, 0.5%F.S
Power Supply	DC 10~30V
Process Connector	G3/8,G1/2,G3/4,G1 inch,1/4"NPT,1/2"NPT,R1 inch,Customizable
Electric Connection	DIN43650 Hirschmann Connector, IP65; M12 4 Pins connector, IP67; Direct lead, IP68;
Working Temp	-20~80°C
Overload Pressure	150%FS
Contact Medium Material	304 stainless steel, 316L stainless steel, Hastelloy alloy, Customizable
Response Time	≤10ms

## OVERALL DIMENSIONS

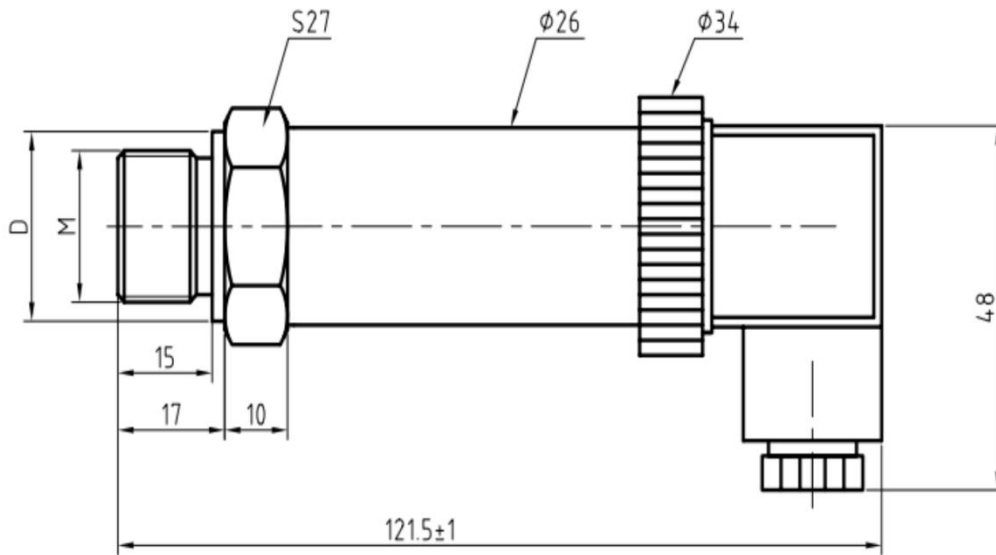

## PRODUCT CONNECTION MODE

### Angular connector DIN 175301-803 C

		2-wire	3-wire
	$U_B$	1	1
	0V	2	2
	S+	-	3

# PRODUCT SELECTION TABLE

Code								
ZJX-PA-S1	High-Pressure Pressure Transmitter							
	Code	Pressure Mode						
	G	Gauge Pressure						
	A	Absolute Pressure						
		Code	Pressure Range					
		Fill In The Actual Demand	0~6000bar					
		Code	Output/Communication					
		O1	4-20mA					
		O2	0-10V					
		O3	0-5V					
		O4	RS485					
		O5	Customizable					
		Code	Process Connection					
		S1	G3/8					
		S2	G1/2					
		S3	G3/4					
		S4	G1 inch					
		S5	1/4"NPT					
		S6	1/2"NPT					
		S7	R1 inch					
		S8	Customizable					
		Code	Accuracy					
		C1	0.25%F.S					
		C2	0.5%F.S					
		C3	Customizable					
		Code	Shell Material					
		T1	304 stainless steel					
		T2	316 stainless steel					
		T3	Hastelloy alloy					
		T4	Customizable					
		Code	Electrical Connection/Waterproofing Level					
		H	DIN43650 Hirschmann Connector, IP65					
		M	M12 4 Pins Connector, IP67					
		L	Locking the outgoing line, IP68					
ZJX-PA-S1	G	0-4000bar	O1	S3	C2	T1	H	Model No.Example

**ZIJUXING**

HUNAN ZIJUXING TECHNOLOGY CO., LTD.

Tel: +86-731-85473669

Fax: +86-731-85473669

E-mail: postmaster@zjxsensor.com web: www.zjxsensor.com

Address: No. 319, Linyu Road, High tech Development Zone, Changsha City, Hunan Province, China